

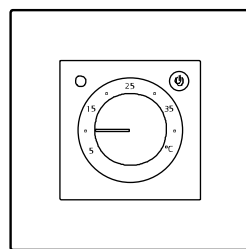

Electronic Heating Thermostat Grand Meyer MST-9



Installation Instructions



Please scan the QR code to access the product manual, videos, and other related information.

This electronic thermostat is designed for installation in a standard wall box. It allows for adjustable temperature settings ranging from 5°C to +45°C. The illuminated LED indicates that the heating is active. This thermostat is recommended for controlling electric heating devices.

Technical Data

Voltage	AC 230V ±10%, 50–60Hz
Power Consumption	4 W MAX
Setting Range	5-45 °C
Ambient Temperature	-5-50 °C
Protection level	IP20
Housing Material	Flame-retardant PC
Switching Deviation	±1 °C
Temperature Sensor	Sensor lead wire length: 3m

Dimension

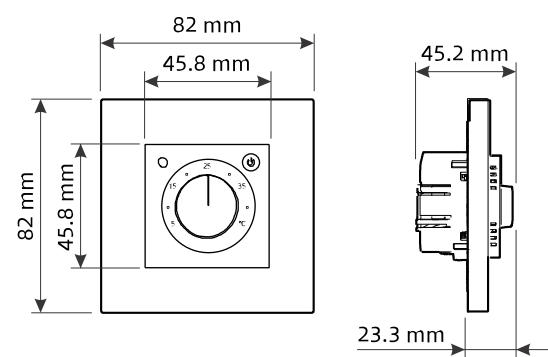

Operation Manual

- 1 Power on/off
- 2 Temperature Setting: From +5°C to +45°C
- 3
 - When the device is turned on, the indicator light turns green.
 - When heating is activated, the indicator light turns red.

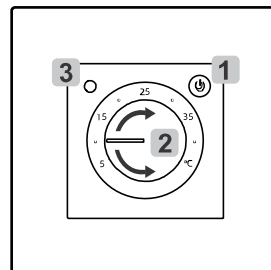

Temperature Setting

The thermostat operates within a temperature range of 5°C to 45°C.

To adjust temperature:

- Clockwise rotation: Increases set temperature
- Counterclockwise rotation: Decreases set temperature

Mounting of Floor Sensor

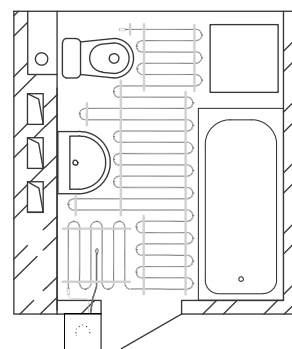

Temperature and Value of Floor Sensor

Temperature (°C)	Value (Ω)
5	22265
10	18074
20	12117
30	8302
40	5809



Device Installation

⚠ Notice:

This instruction and connection diagram do not replace the professional training of the installer. We recommend using the services of qualified specialists for the installation of the thermostat and heating system. Electrical connections and the connection of the device to the power supply should be performed by a qualified electrician. All installation and connection work should be carried out with the power supply turned off.

1. Remove the casing away from the panel.

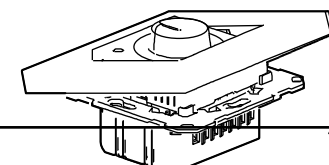

2. Please connect the wires to the corresponding terminals according to the following wiring diagram (recommended strip length 5~7 mm), then tighten the screws to secure.

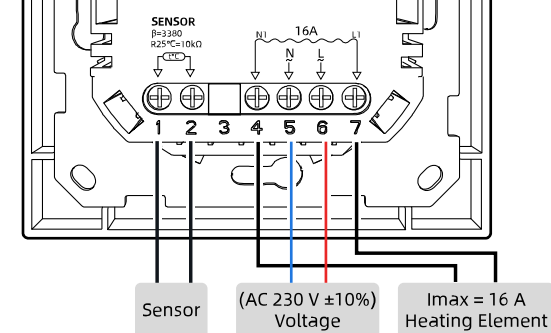

Important: An external temperature sensor must be connected for proper device operation. The indicator LED will flash green if no sensor is detected.

3. Once the wiring is done, use two screws to attach the back cover to the wall box.

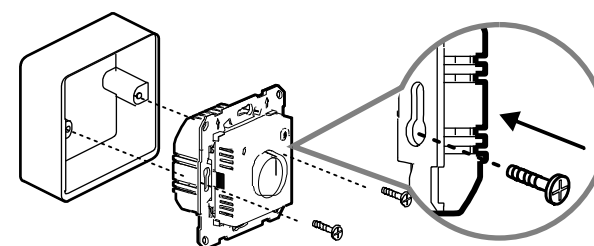

4. Confirm the position of the device buckle.

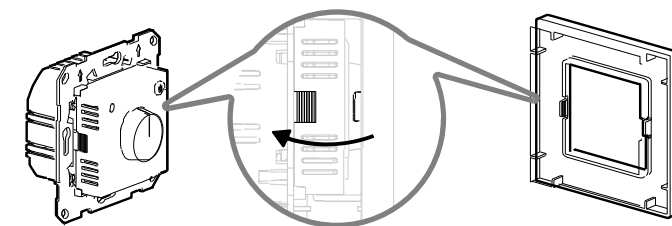

5. Align the casing frame with the panel clips, snap the panel into place, and complete the installation.

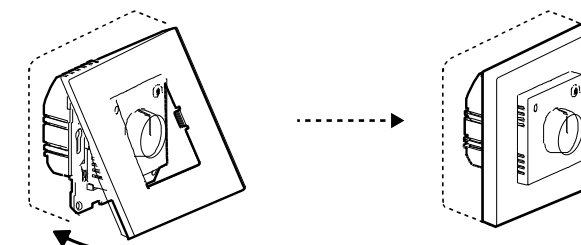

Disposal of Obsolete Equipment



Devices with this marking must not be disposed of with regular waste. They should be collected separately and disposed of in accordance with local regulations.